

Son áireamh tá sonraíocht Shuirbhíreachtí Ordánais Éireann arna aistriú go dtí físeán Cheadúna OSI Uimh. 2010/18CCMA/Comhairle Contae na Gaillimhe. Sírúinn aistriú go dtí na h-áireamhí na h-Éireann agus Rialtas na hÉireann. © Suirbhíreacht Ordánais Éireann, 2010.

© Suirbhíreacht Ordánais Éireann. Gach ceart ar chosaint. Uimhir cheadúna 2010/18CCMA/Comhairle Contae na Gaillimhe.

Includes Ordnance Survey Ireland data reproduced under OSI Licence number 2010/18CCMA/Galway County Council. Unauthorised reproduction infringes Ordnance Survey Ireland and Government of Ireland copyright. © Ordnance Survey Ireland, 2010.

© Ordnance Survey Ireland. All rights reserved. Licence number 2010/18CCMA/Galway County Council.

Clients

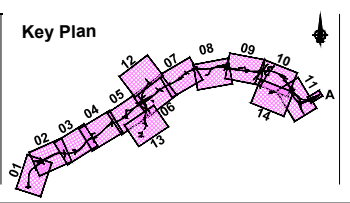

Consultant

Corporate House
City East Business Park
Ballybrnt, Galway, Ireland.

Tel +353 (0)91 460675
www.N6GalwayCity.ie
www.arup.ie

Job Title
N6 Galway City Ring Road

Scale
1:20,000 @ A1, 1:40,000 @ A3

Date
February 2018

Issue	Date	By	Chkd	Appd
I4	12/03/2018	KJ	HK	EMC
I3	22/02/2018	KJ	HK	EMC
I2	11/07/2017	PC	HK	EMC
I1	04/05/2016	PC	HK	EMC

Drawing Title
Section 50 Application Key Plan

Drawing Status
For Information

Job No
233985

Drawing No
GCOB-500-D-500

Issue
14

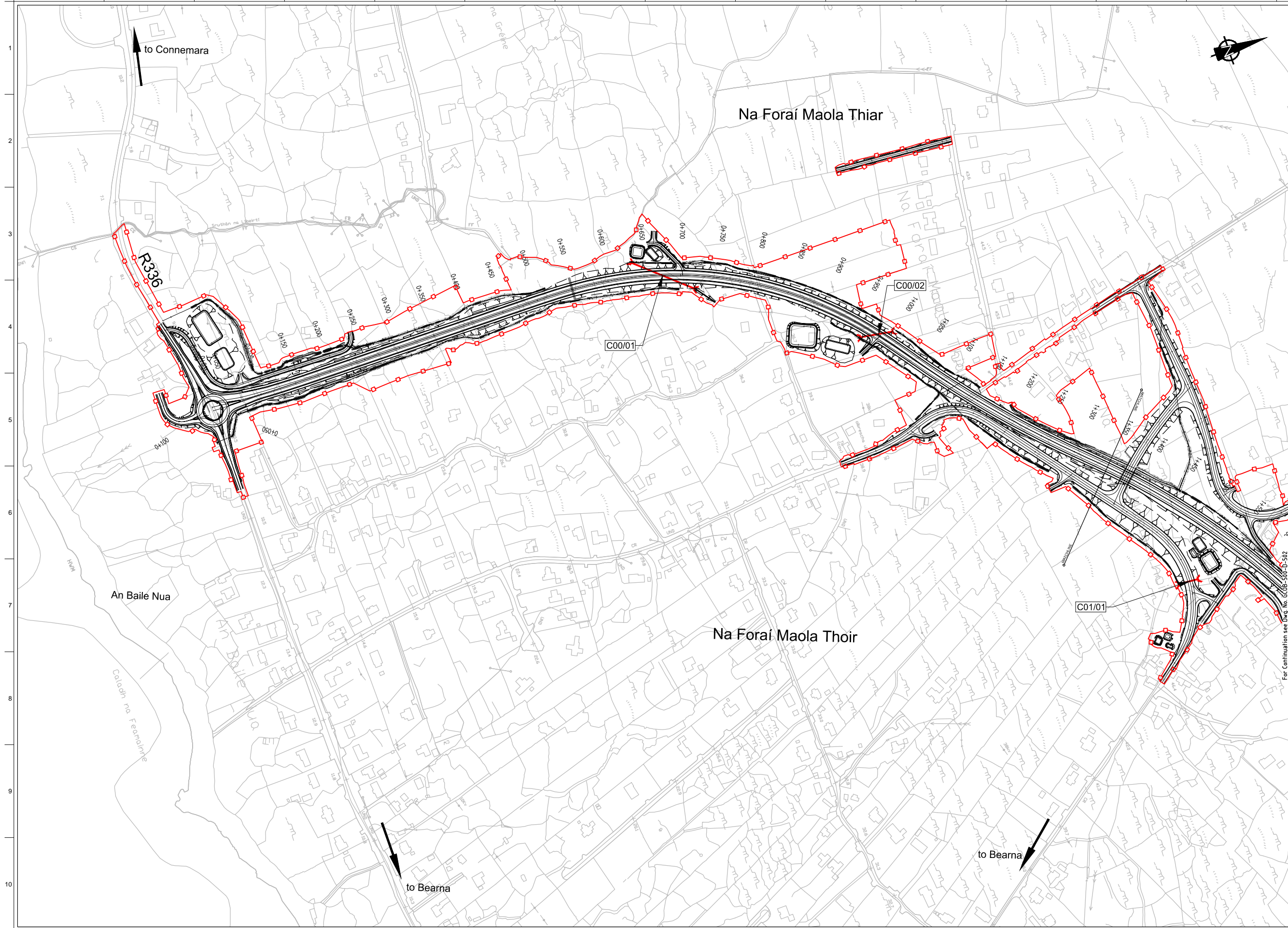

DESIGN REPORT

Legend:

- City Boundary
- Proposed Development Boundary
- Proposed Road Development
- Proposed Culvert
- Proposed Attenuation Pond / Infiltration Basin / Wetlands

San áireamh tá sonraíocht Shuirbhíreacha Orlándaís Éireann arna atáirgeadh fust Cheadúnas OSI Uimh. 2010/18CCMA/Comhairle Contae na Gaillimhe. Sírúisinn atáirgeadh neamhdaraithe cóipeacht Shuirbhíreacha Orlándaís Éireann agus Rialtas na hÉireann. © Suirbhíreacha Orlándaís Éireann, 2010.

© Suirbhíreacha Orlándaís Éireann. Gach ceart ar chosaint. Uimhir cheadúnais 2010/18CCMA/Comhairle Contae na Gaillimhe.

Includes Ordnance Survey Ireland data reproduced under OSI Licence number 2010/18CCMA/Galway County Council. Unauthorised reproduction infringes Ordnance Survey Ireland and Government of Ireland copyright. © Ordnance Survey Ireland, 2010.

© Ordnance Survey Ireland. All rights reserved. Licence number 2010/18CCMA/Galway County Council.

Clients

Comhairle Chontae na Gaillimhe
Galway County Council

N6 Galway City Transport Project

An Roinn Iompair
Turasóireachta agus Spóirt

TII
Bonnagar Iompar Éireann

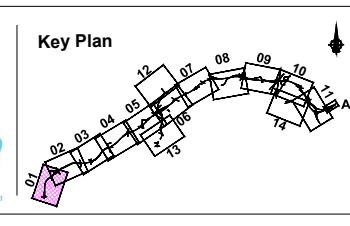

Consultant

ARUP

Corporate House
City East Business Park
Ballybrit, Galway, Ireland.

Tel +353 (0)91 460675
www.N6GalwayCity.ie
www.arup.ie

Job Title
N6 Galway City Ring Road

Scale
1:5000 @ A3

Date:
February 2018

I3	22/02/2018	KJ	HK	EMC
I2	11/07/2017	PC	CNM	EMC
I1	04/05/2016	PC	HK	EMC
Issue	Date	By	Chkd	Appd

Drawing Title
Section 50 Application
Plan Layout CH.0+000 to CH.1+350
Sheet 1 of 14

Drawing Status

For Information

Job No	Drawing No	Issue
233985	GCOB-500-D-501	13

DESIGN REPORT

- Legend:**
- City Boundary
 - Proposed Development Boundary
 - Proposed Road Development
 - Proposed Culvert
 - Proposed Attenuation Pond / Infiltration Basin / Wetlands

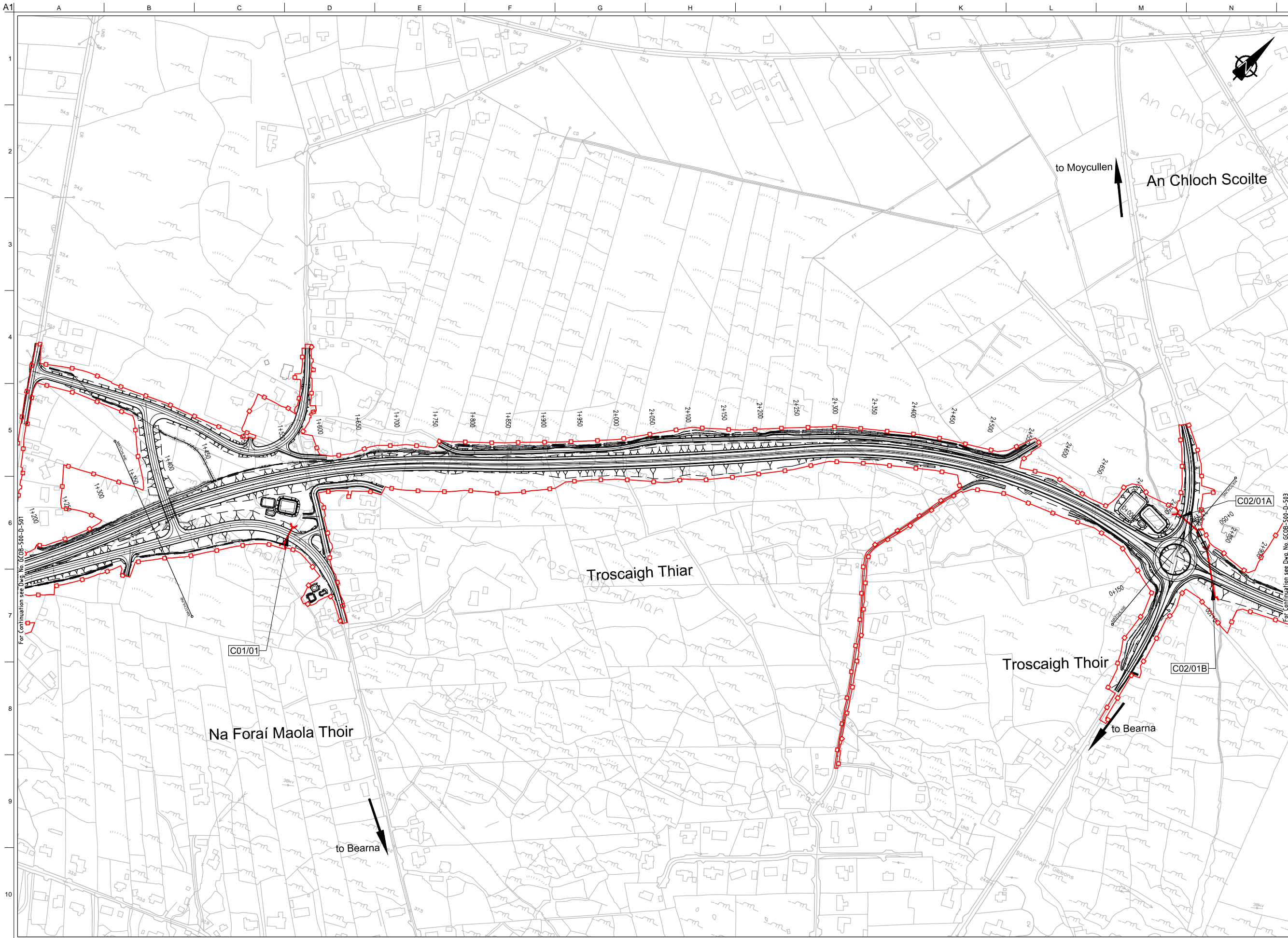

Son áireamh tá sonraíocht Shuirbhíreachtí Orlánais Éireann arna aistriú go dtailíúm físe Chéadainn OSI Uimh. 2010/18CCMA/Comhairle Contae na Gaillimhe. Sírtaíonn aistriú go dtailíúm físe na hÉireann agus Rialtas na hÉireann. © Suirbhíreacht Orlánais Éireann, 2010.

© Suirbhíreacht Orlánais Éireann. Gach ceart ar chosaint. Uimhir cheadainn 2010/18CCMA/Comhairle Contae na Gaillimhe.

Includes Ordnance Survey Ireland data reproduced under OSI Licence number 2010/18CCMA/Galway County Council. Unauthorised reproduction infringes Ordnance Survey Ireland and Government of Ireland copyright. © Ordnance Survey Ireland, 2010.

© Ordnance Survey Ireland. All rights reserved. Licence number 2010/18CCMA/Galway County Council.

Clients

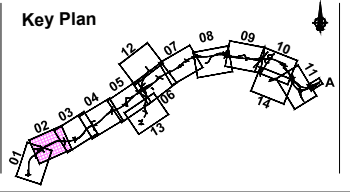

Consultant

Corporate House
City East Business Park
Ballybrit, Galway, Ireland.

Tel +353 (0)91 460675
www.N6GalwayCity.ie
www.arup.ie

Job Title
N6 Galway City Ring Road

Scale
1:5000 @ A3

Date:
February 2018

Issue	Date	By	Chkd	Appd
I3	22/02/2018	KJ	HK	EMC
I2	11/07/2017	PC	HK	EMC
I1	04/05/2016	PC	HK	EMC

Drawing Title
Section 50 Application
Plan Layout CH.1+350 to CH.2+799
Sheet 2 of 14

Drawing Status

For Information

Job No	Drawing No	Issue
233985	GC0B-500-D-502	13

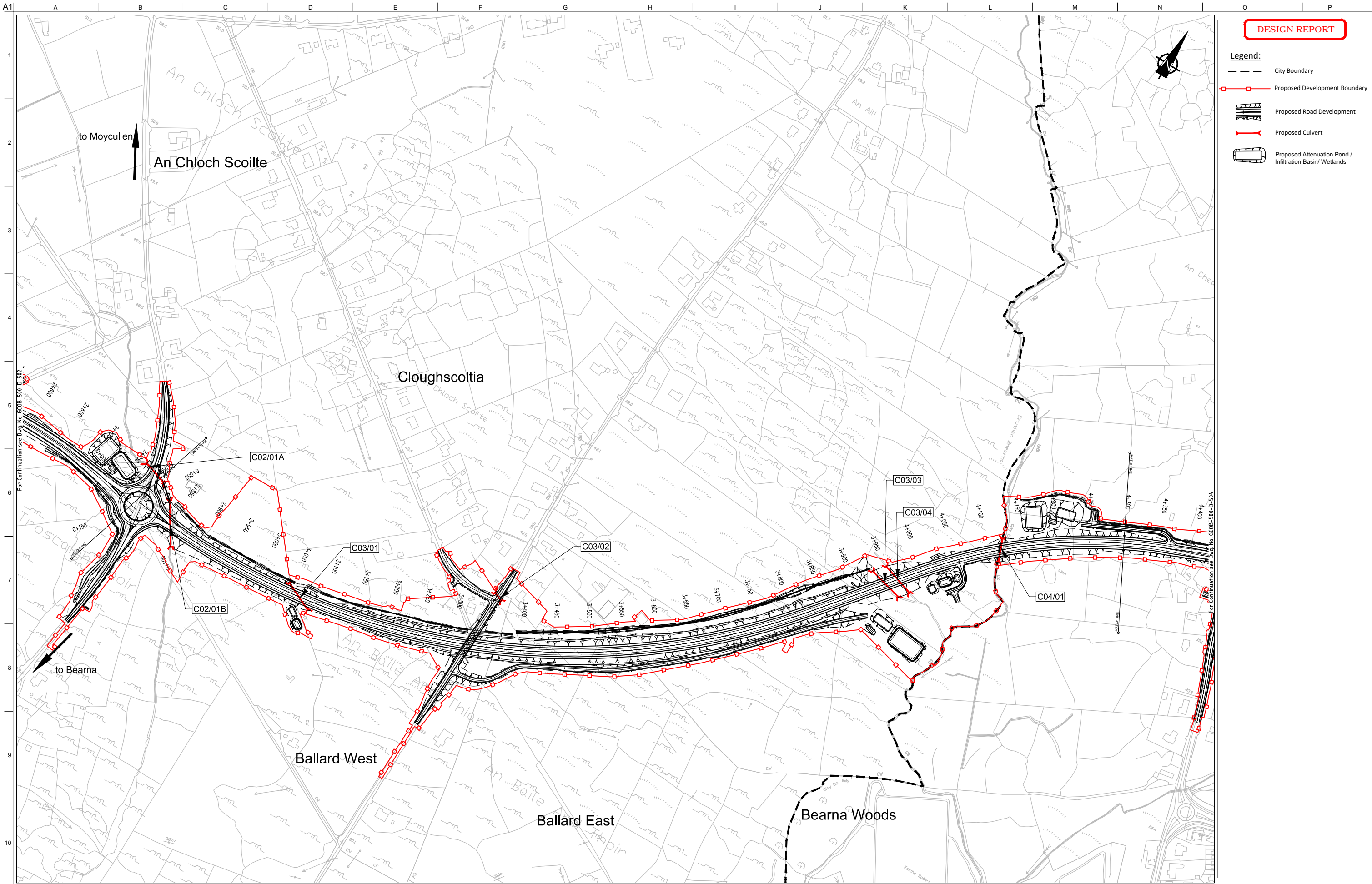

DESIGN REPORT

- Legend:**
- City Boundary
 - Proposed Development Boundary
 - Proposed Road Development
 - Proposed Culvert
 - Proposed Attenuation Pond / Infiltration Basin / Wetlands

Son áireamh tá sonraíocht Shuirbhíreacht Orláinís Éireann arna aistriú go dtí fás Cheadúnas OSI Uimh. 2010/18CCMA/Comhairle Contae na Gaillimhe. Sírúinn aistriú go dtí neamhdarúnaíocht cóipeacht Shuirbhíreacht Orláinís Éireann agus Rialtas na hÉireann. © Suirbhíreacht Orláinís Éireann, 2010.

© Suirbhíreacht Orláinís Éireann. Gach ceart ar chosaint. Uimhir cheadúnas 2010/18CCMA/Comhairle Contae na Gaillimhe.

Includes Ordnance Survey Ireland data reproduced under OSI Licence number 2010/18CCMA/Galway County Council. Unauthorised reproduction infringes Ordnance Survey Ireland and Government of Ireland copyright. © Ordnance Survey Ireland, 2010.

© Ordnance Survey Ireland. All rights reserved. Licence number 2010/18CCMA/Galway County Council.

Clients

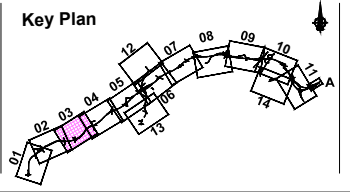

Consultant

Corporate House
City East Business Park
Ballybrit, Galway, Ireland.

Tel +353 (0)91 460675
www.N6GalwayCity.ie
www.arup.ie

Job Title
N6 Galway City Ring Road

Scale
1:5000 @ A3

Date:
February 2018

Issue	Date	By	Chkd	Appd
I3	22/02/2018	KJ	HK	EMC
I2	11/07/2017	PC	HK	EMC
I1	04/05/2016	PC	HK	EMC

Drawing Title
Section 50 Application
Plan Layout CH.2+799 to CH.4+300
Sheet 3 of 14

Drawing Status

For Information

Job No	Drawing No	Issue
233985	GCOB-500-D-503	13

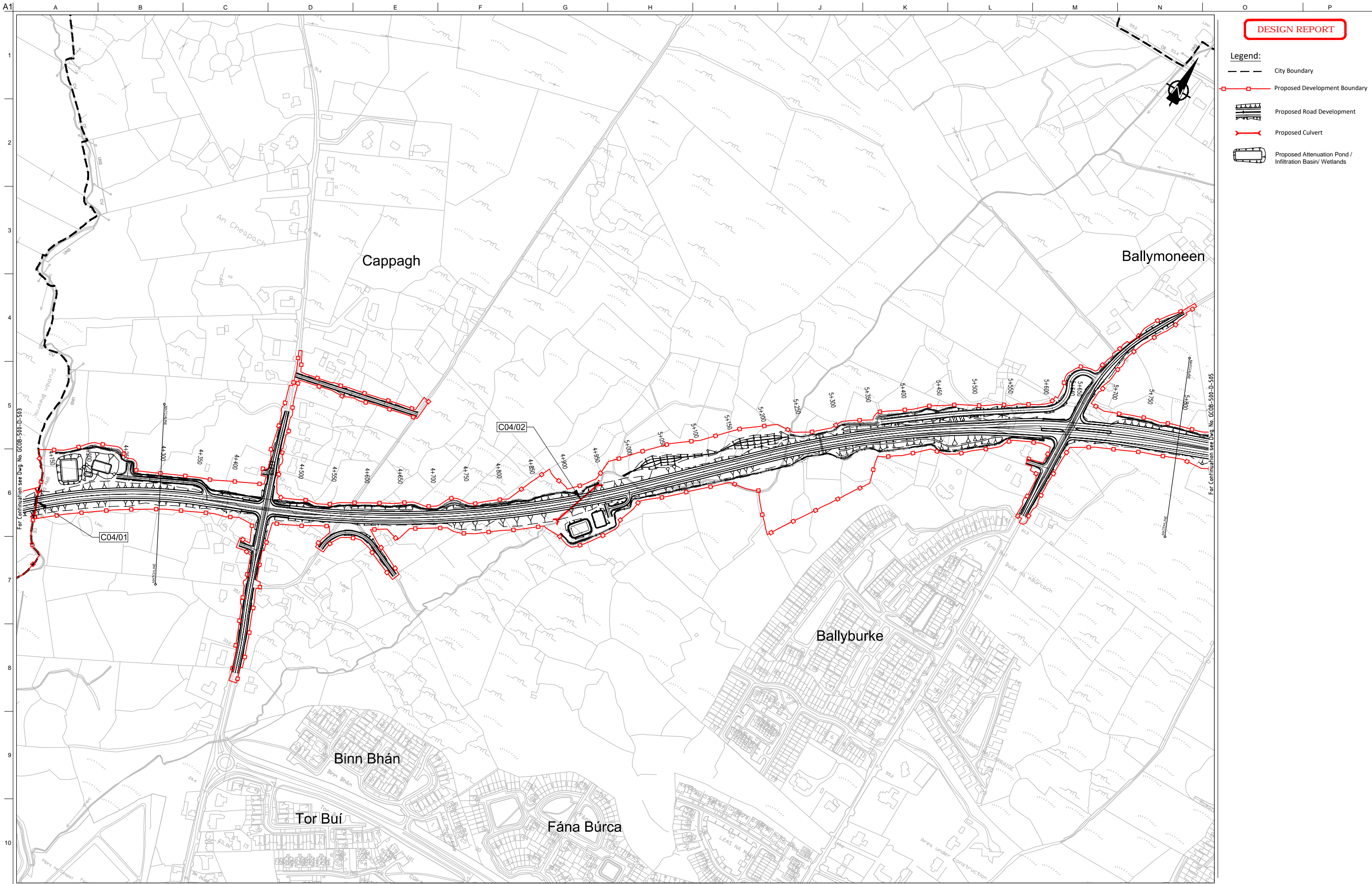

DESIGN REPORT

- Legend:**
- City Boundary
 - Proposed Development Boundary
 - Proposed Road Development
 - Proposed Culvert
 - Proposed Attenuation Pond / Infiltration Basin / Wetlands

Son áireamh tá sonraíocht Shuirbhíreachtí Orlándaís Éireann arna atáirgeadh fúis Cheadúnas OSÍ Uimh. 2010/18CCMA/Comhairle Contae na Gaillimhe. Sírtaíonn atáirgeadh neamhdhártaíche cóipeacht Shuirbhíreachtí Orlándaís Éireann agus Rialtas na hÉireann. © Suirbhíreacht Orlándaís Éireann, 2010.

© Suirbhíreacht Orlándaís Éireann. Gach ceart ar chosaint.
Uimhir cheadúnais 2010/18CCMA/Comhairle Contae na Gaillimhe.

Includes Ordnance Survey Ireland data reproduced under OSI Licence number 2010/18CCMA/Galway County Council. Unauthorised reproduction infringes Ordnance Survey Ireland and Government of Ireland copyright. © Ordnance Survey Ireland, 2010.

© Ordnance Survey Ireland. All rights reserved. Licence number 2010/18CCMA/Galway County Council.

Clients

Comhairle Chontae na Gaillimhe
Galway County Council

N6 Galway City Transport Project

An Roimp Iompair
Turasóireacht agus Spóirt

TIU
Bonnagar Iompair Éireann

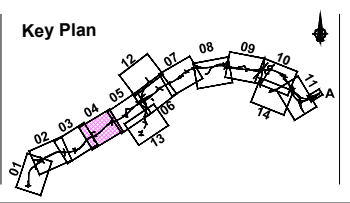

Consultant

ARUP

Corporate House
City East Business Park
Ballybrit, Galway, Ireland.

Tel +353 (0)91 460675
www.N6GalwayCity.ie
www.arup.ie

Job Title
N6 Galway City Ring Road

Scale
1:5000 @ A3

Date:
February 2018

I3	22/02/2018	KJ	HK	EMC
I2	11/07/2017	PC	HK	EMC
I1	04/05/2016	PC	HK	EMC
Issue	Date	By	Chkd	Appd

Drawing Title
Section 50 Application
Plan Layout CH.4+300 to CH.5+800
Sheet 4 of 14

Drawing Status

For Information

Job No	Drawing No	Issue
233985	GC0B-500-D-504	13

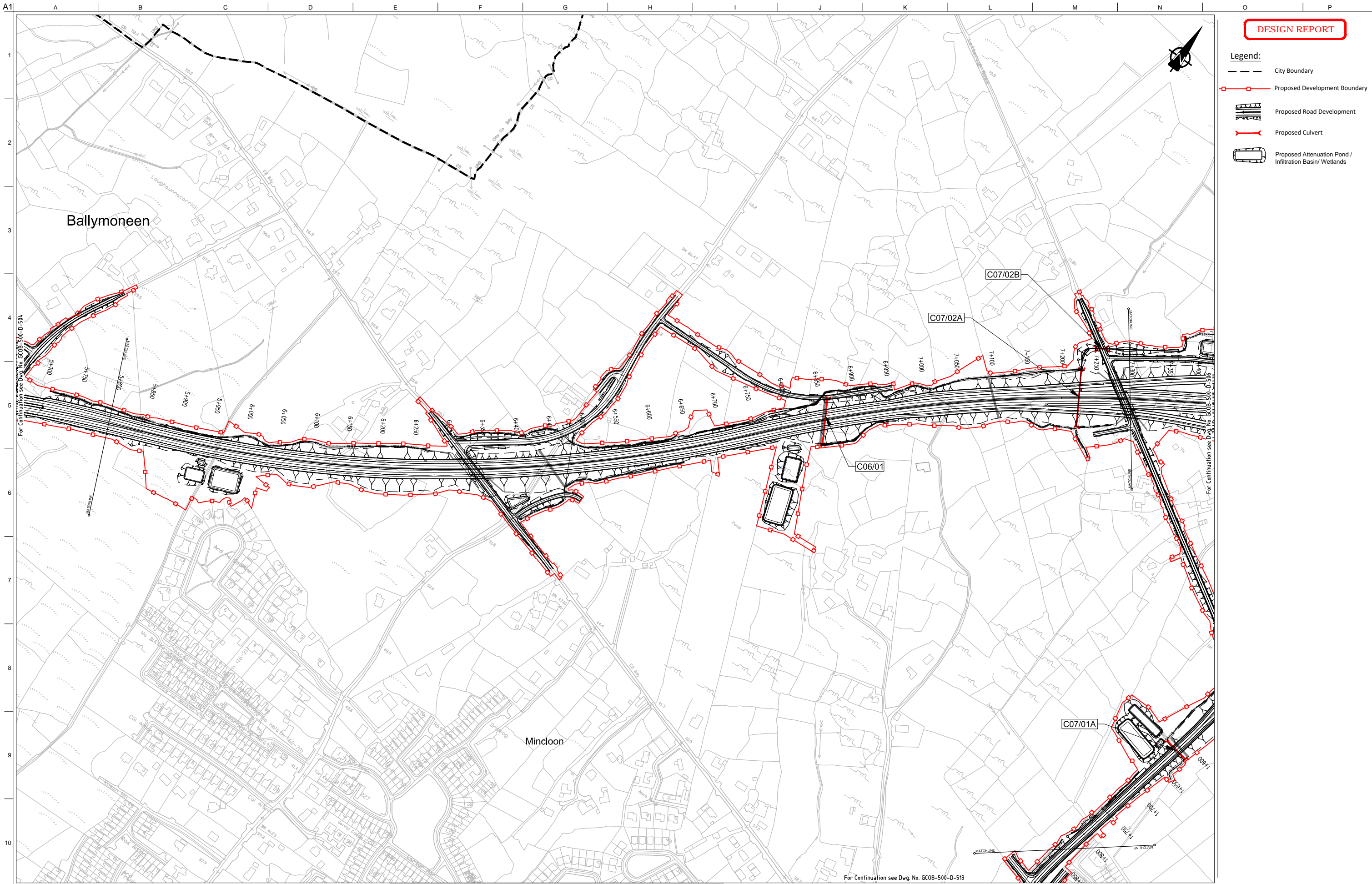

DESIGN REPORT

- Legend:**
- City Boundary
 - Proposed Development Boundary
 - Proposed Road Development
 - Proposed Culvert
 - Proposed Attenuation Pond / Infiltration Basin / Wetlands



Son áireamh tá sonraíocht Shuirbhíreacht Orláinís Éireann arna áitirgeadh fust Cheadúnas OSÍ Uimh. 2010/18CCMA/Comhairle Contae na Gaillimhe. Sírúinn áitirgeadh neamhdaraithe cóipeacht Shuirbhíreacht Orláinís Éireann agus Rialtas na hÉireann. © Suirbhíreacht Orláinís Éireann, 2010.

© Suirbhíreacht Orláinís Éireann. Gach ceart ar chosaint. Uimhir cheadúnais 2010/18CCMA/Comhairle Contae na Gaillimhe.

Includes Ordnance Survey Ireland data reproduced under OSI Licence number 2010/18CCMA/Galway County Council. Unauthorised reproduction infringes Ordnance Survey Ireland and Government of Ireland copyright. © Ordnance Survey Ireland, 2010.

© Ordnance Survey Ireland. All rights reserved. Licence number 2010/18CCMA/Galway County Council.

Clients

Comhairle Chontae na Gaillimhe
Galway County Council

Galway City Transport Project

An Roipín Iompair
Turasóireacht agus Spóirt

TII
Bonnagar Iompar Éireann

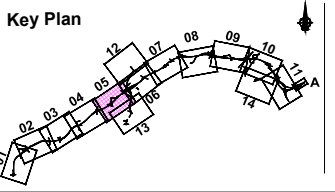

Consultant

ARUP

Corporate House
City East Business Park
Ballybrit, Galway, Ireland.

Tel +353 (0)91 460675
www.N6GalwayCity.ie
www.arup.ie

Job Title
N6 Galway City Ring Road

Scale
1:5000 @ A3

Date:
February 2018

Issue	Date	By	Chkd	Appd
I3	22/02/2018	KJ	HK	EMC
I2	11/07/2017	PC	HK	EMC
I1	04/05/2016	PC	HK	EMC

Drawing Title
Section 50 Application
Plan Layout CH.5+800 to CH.7+300
Sheet 5 of 14

Drawing Status

For Information

Job No	Drawing No	Issue
233985	GC08-500-D-505	13

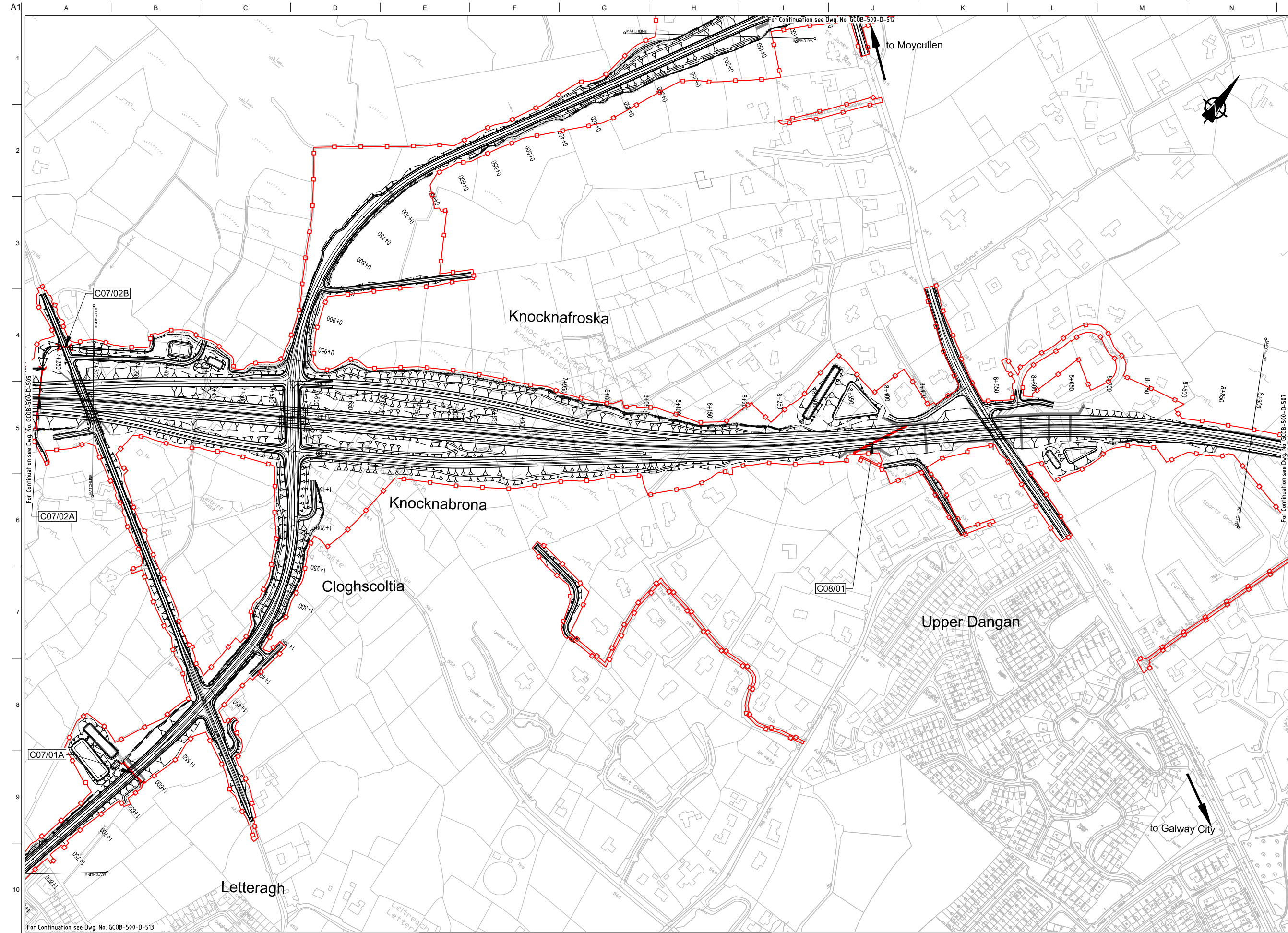

DESIGN REPORT

Legend:

- City Boundary
- Proposed Development Boundary
- Proposed Road Development
- Proposed Culvert
- Proposed Attenuation Pond / Infiltration Basin / Wetlands

San áirímh tá sonraíocht Shuirbhíreacha Ordánais Éireann arna áitirgeadh fúis Cheadúnas OSI Uimh. 2010/18CCMA/Comhairle Contae na Gaillimhe. Sírúinn áitirgeadh neamhdaraithe cóipeacht Shuirbhíreacha Ordánais Éireann agus Rialtas na hÉireann. © Suirbhíreacha Ordánais Éireann, 2010.

© Suirbhíreacha Ordánais Éireann. Gach ceart ar chosaint. Uimhir cheadúnais 2010/18CCMA/Comhairle Contae na Gaillimhe.

Includes Ordnance Survey Ireland data reproduced under OSI Licence number 2010/18CCMA/Galway County Council. Unauthorised reproduction infringes Ordnance Survey Ireland and Government of Ireland copyright. © Ordnance Survey Ireland, 2010.

© Ordnance Survey Ireland. All rights reserved. Licence number 2010/18CCMA/Galway County Council.

Clients

Comhairle Chontae na Gaillimhe
Galway County Council

ARUP
Galway City Transport Project

An Roinn Iompair
Turasóireacht agus Spóirt

TII
Borradóir Iompair Éireann

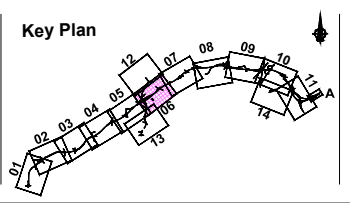

Consultant

ARUP

Corporate House
City East Business Park
Ballybrit, Galway, Ireland.

Tel +353 (0)91 460675
www.N6GalwayCity.ie
www.arup.ie

Job Title
N6 Galway City Ring Road

Scale
1:5000 @ A3

Date:
February 2018

I3	22/02/2018	KJ	HK	EMC
I2	11/07/2017	PC	HK	EMC
I1	04/05/2017	PC	HK	EMC
Issue	Date	By	Chkd	Appd

Drawing Title
Section 50 Application
Plan Layout CH.7+300 to CH.8+900
Sheet 6 of 14

Drawing Status

For Information

Job No	Drawing No	Issue
233985	GCOB-500-D-506	13

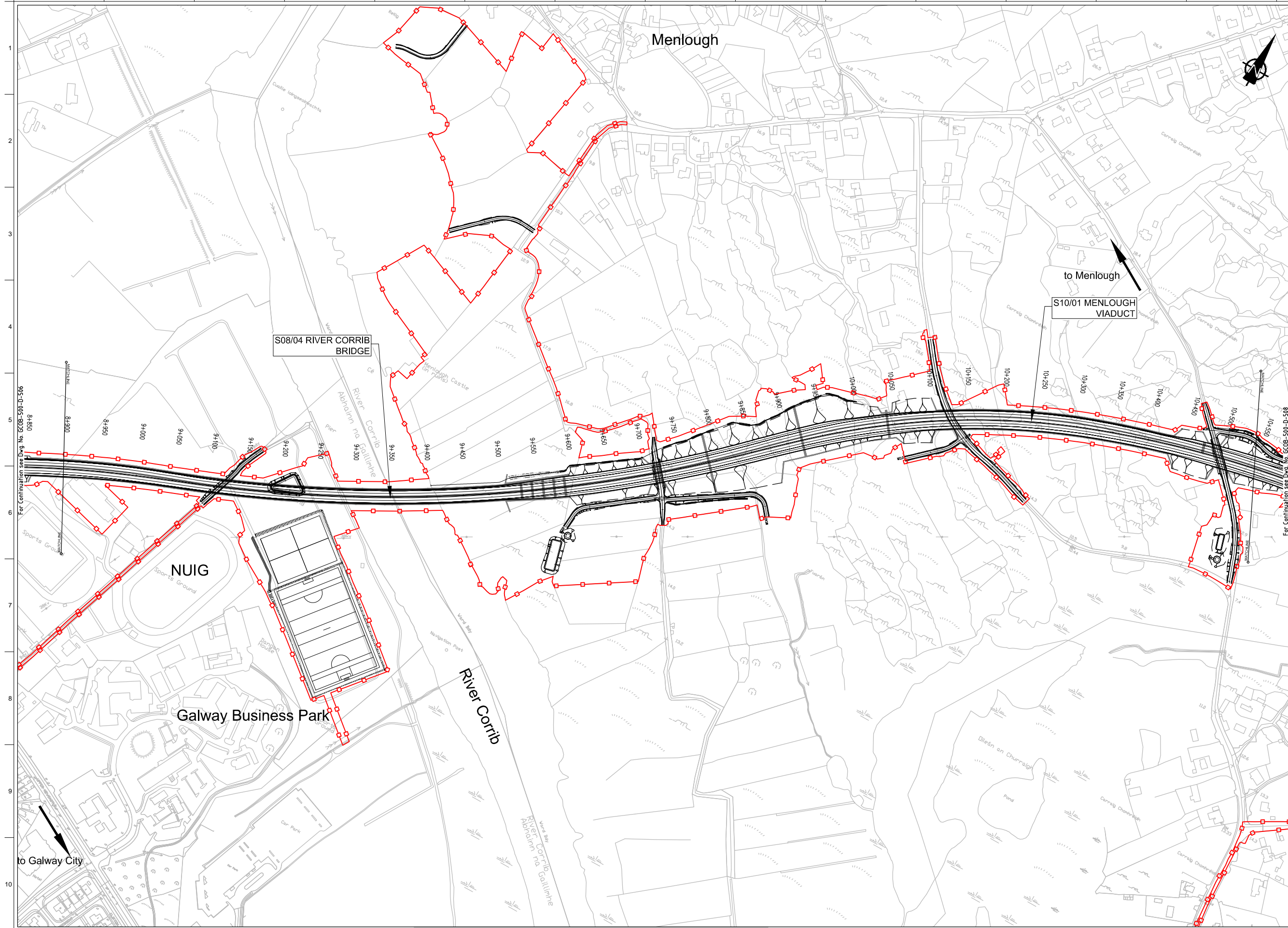

DESIGN REPORT

Legend:

- City Boundary
- Proposed Development Boundary
- Proposed Road Development
- Proposed Culvert
- Proposed Attenuation Pond / Infiltration Basin / Wetlands

For Continuation see Dwg No. GCOB-500-D-506

For Continuation see Dwg No. GCOB-500-D-508

Son áireamh tá sonraíocht Shuirbhíreachtí Ordánais Éireann arna atáirgeadh fúis Cheadúnas OSI Uimh. 2010/18CCMA/Comhairle Contae na Gaillimhe. Sírtaíonn atáirgeadh neamhdharaíthe cóipeacht Shuirbhíreachtí Ordánais Éireann agus Rialtas na hÉireann. © Suirbhíreachtí Ordánais Éireann, 2010.

© Suirbhíreachtí Ordánais Éireann. Gach ceart ar chosaint. Uimhir cheadúnais 2010/18CCMA/Comhairle Contae na Gaillimhe.

Includes Ordnance Survey Ireland data reproduced under OSI Licence number 2010/18CCMA/Galway County Council. Unauthorised reproduction infringes Ordnance Survey Ireland and Government of Ireland copyright. © Ordnance Survey Ireland, 2010.

© Ordnance Survey Ireland. All rights reserved. Licence number 2010/18CCMA/Galway County Council.

Clients

Comhairle Chontae na Gaillimhe
Galway County Council

An Roipp Iompair
Turasóireacht agus Spóirt

TII
Bonnagar Iompar Éireann

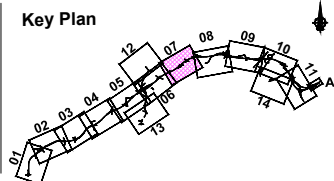

Consultant

ARUP

Corporate House
City East Business Park
Ballybrit, Galway, Ireland.

Tel +353 (0)91 460675
www.N6GalwayCity.ie
www.arup.ie

Job Title
N6 Galway City Ring Road

Scale
1:5000 @ A3

Date:
February 2018

I4	12/03/2018	KJ	HK	EMC
I3	22/02/2018	KJ	HK	EMC
I2	11/07/2017	PC	HK	EMC
I1	04/05/2016	PC	HK	EMC
Issue	Date	By	Chkd	Appd

Drawing Title
Section 50 Application
Plan Layout CH.8+900 to CH.10+550
Sheet 7 of 14

Drawing Status

For Information

Job No	Drawing No	Issue
233985	GCOB-500-D-507	14

DESIGN REPORT

- Legend:**
- City Boundary
 - Proposed Development Boundary
 - Proposed Road Development
 - Proposed Culvert
 - Proposed Attenuation Pond / Infiltration Basin / Wetlands

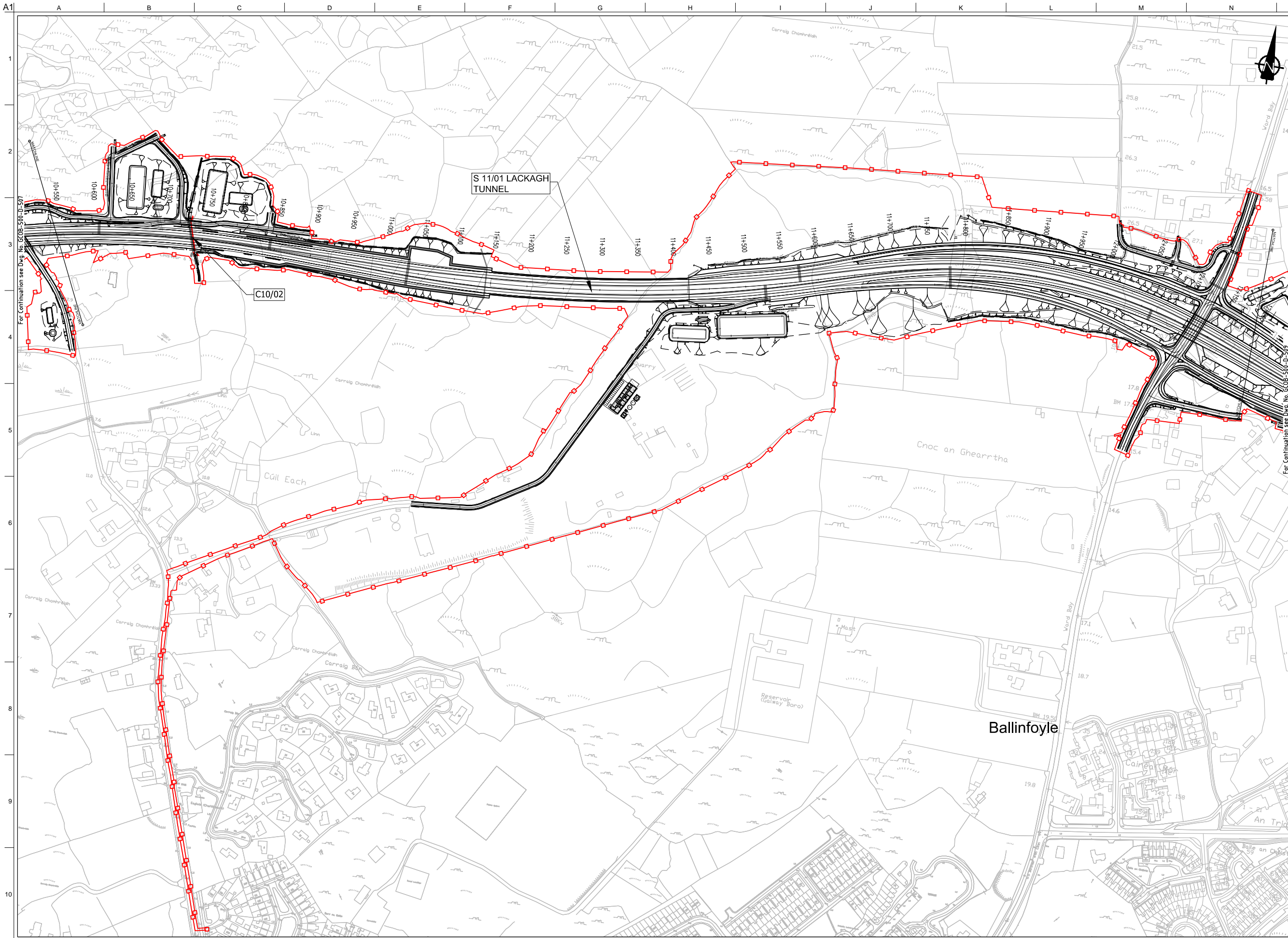

Son áireamh tá sonraíocht Shuirbhíreacht Ordoánais Éireann arna aistriú go dtí físeán OSI Uimh. 2010/18CCMA/Comhairle Contae na Gaillimhe. Sírtaíonn aistriú na n-ábairí seo cópáil Shuirbhíreacht Ordoánais Éireann agus Rialtas na hÉireann. © Shuirbhíreacht Ordoánais Éireann, 2010.

© Shuirbhíreacht Ordoánais Éireann. Gach ceart ar chosaint. Uimhir cheadúnais 2010/18CCMA/Comhairle Contae na Gaillimhe. Includes Ordnance Survey Ireland data reproduced under OSI Licence number 2010/18CCMA/Galway County Council. Unauthorised reproduction infringes Ordnance Survey Ireland and Government of Ireland copyright. © Ordnance Survey Ireland, 2010.

© Ordnance Survey Ireland. All rights reserved. Licence number 2010/18CCMA/Galway County Council.

Clients

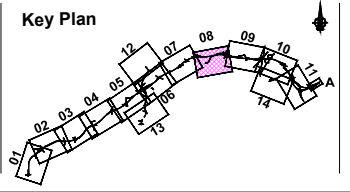

Consultant

Corporate House
City East Business Park
Ballybrit, Galway, Ireland.

Tel +353 (0)91 460675
www.N6GalwayCity.ie
www.arup.ie

Job Title
N6 Galway City Ring Road

Scale
1:5000 @ A3

Date:
February 2018

I3	22/02/2018	KJ	HK	EMC
I2	11/07/2017	PC	HK	EMC
I1	04/05/2016	PC	HK	EMC
Issue	Date	By	Chkd	Appd

Drawing Title
Section 50 Application
Plan Layout CH.10+550 to CH.12+200
Sheet 8 of 14

Drawing Status

For Information

Job No	Drawing No	Issue
233985	GCOB-500-D-508	13

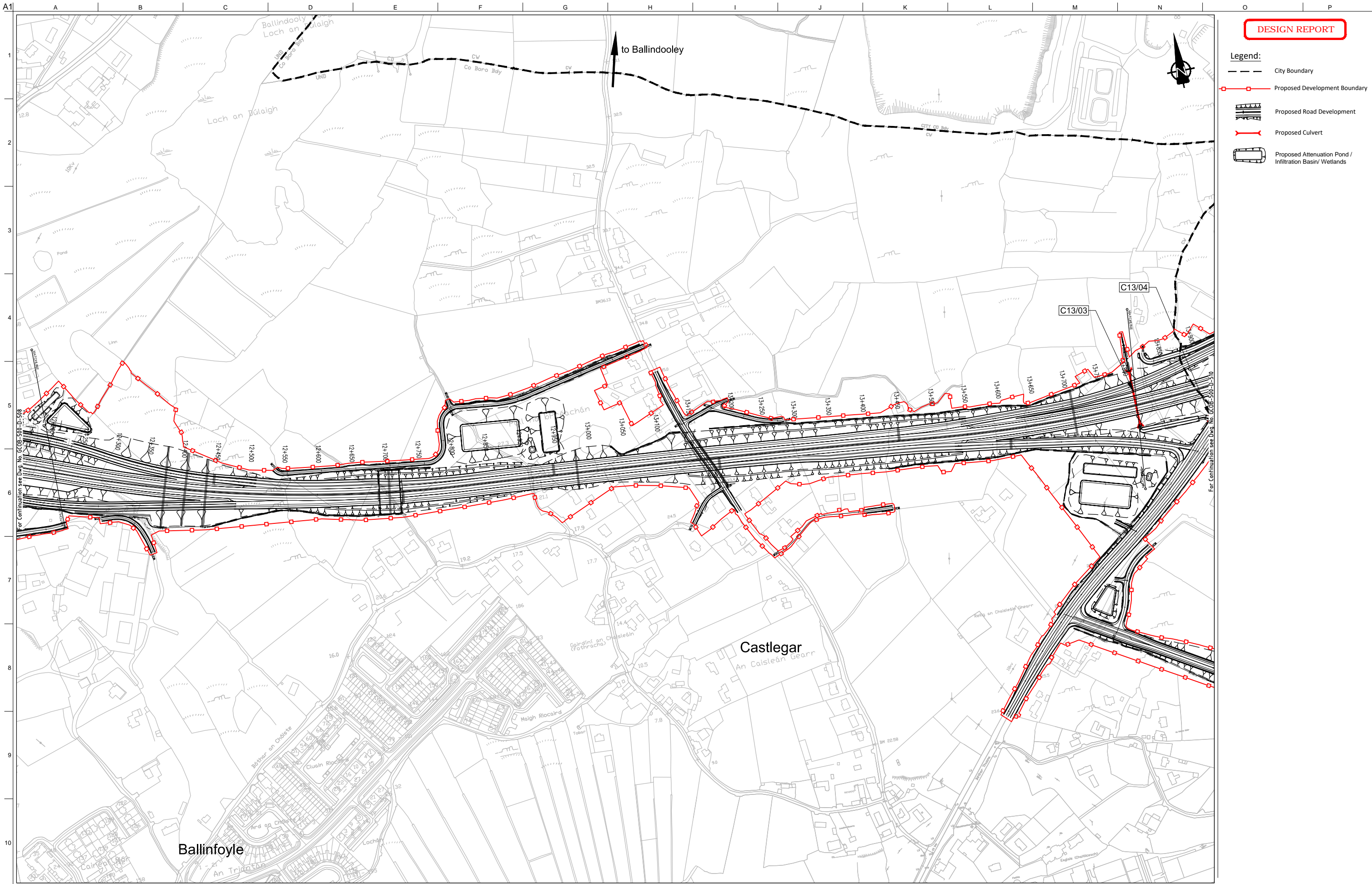

DESIGN REPORT

- Legend:**
- City Boundary
 - Proposed Development Boundary
 - Proposed Road Development
 - Proposed Culvert
 - Proposed Attenuation Pond / Infiltration Basin / Wetlands

Son áireamh tá sonraíocht Shuirbhíreacht Orlánais Éireann arna aistriú go dtí fás Cheadúnas OSI Uimh. 2010/18CCMA/Comhairle Contae na Gaillimhe. Sírúinn aistriú go dtí neamhdhárthaí cóschearta Shuirbhíreacht Orlánais Éireann agus Rialtas na hÉireann. © Suirbhíreacht Orlánais Éireann, 2010.

© Suirbhíreacht Orlánais Éireann. Gach ceart ar chosaint. Uimhir cheadúnais 2010/18CCMA/Comhairle Contae na Gaillimhe.

Includes Ordnance Survey Ireland data reproduced under OSI Licence number 2010/18CCMA/Galway County Council. Unauthorised reproduction infringes Ordnance Survey Ireland and Government of Ireland copyright. © Ordnance Survey Ireland, 2010.

© Ordnance Survey Ireland. All rights reserved. Licence number 2010/18CCMA/Galway County Council.

Clients

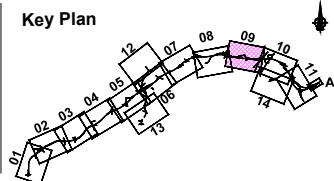

Consultant

Corporate House
City East Business Park
Ballybrit, Galway, Ireland.

Tel +353 (0)91 460675
www.N6GalwayCity.ie
www.arup.ie

Job Title
N6 Galway City Ring Road

Scale
1:5000 @ A3

Date:
February 2018

Issue	Date	By	Chkd	Appd
I3	22/02/2018	KJ	HK	EMC
I2	11/07/2017	PC	HK	EMC
I1	04/05/2016	PC	HK	EMC

Drawing Title
Existing Drainage Network
Plan Layout CH.12+200 to CH.13+800
Sheet 9 of 14

Drawing Status

For Information

Job No	Drawing No	Issue
233985	GCOB-500-D-509	13

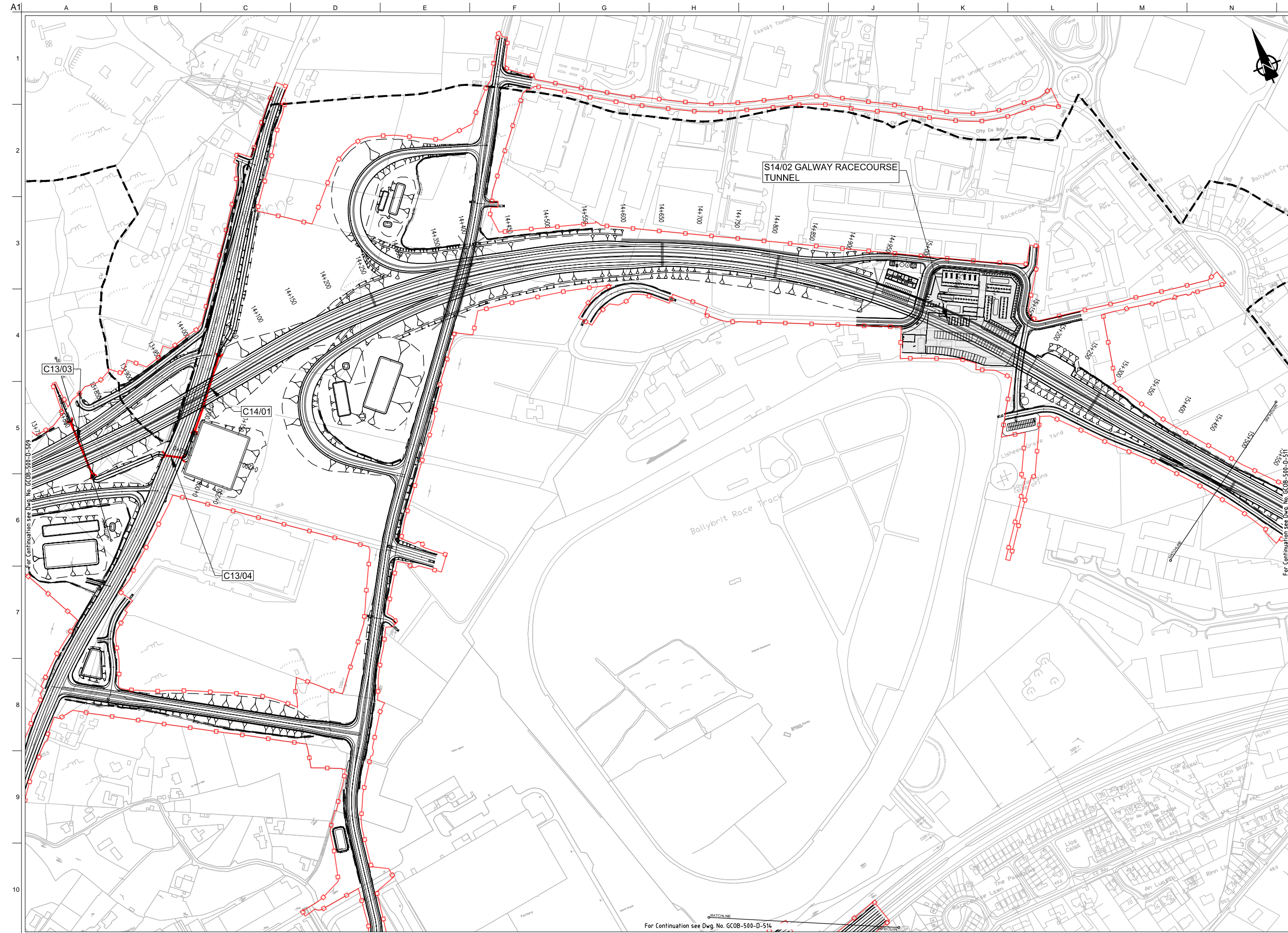

DESIGN REPORT

- Legend:**
- City Boundary
 - Proposed Development Boundary
 - Proposed Road Development
 - Proposed Culvert
 - Proposed Attenuation Pond / Infiltration Basin / Wetlands

S14/02 GALWAY RACECOURSE TUNNEL

C13/03

C14/01

C13/04

For Continuation see Dwg. No. GCOB-500-D-514

For Continuation see Dwg. No. GCOB-500-D-511

Son áireamh tá sonraíocht Shuirbhíreacha Orlándaís Éireann arna aistriú go dtí físeán OSI Uimh. 2010/18CCMA/Comhairle Contae na Gaillimhe. Sírúinn aistriú go dtí físeán na cóschearta Shuirbhíreacha Orlándaís Éireann agus Rialtas na hÉireann. © Suirbhíreacha Orlándaís Éireann, 2010.

© Suirbhíreacha Orlándaís Éireann. Gach ceart ar chosaint. Uimhir cheadúnais 2010/18CCMA/Comhairle Contae na Gaillimhe.

Includes Ordnance Survey Ireland data reproduced under OSI Licence number 2010/18CCMA/Galway County Council. Unauthorised reproduction infringes Ordnance Survey Ireland and Government of Ireland copyright. © Ordnance Survey Ireland, 2010.

© Ordnance Survey Ireland. All rights reserved. Licence number 2010/18CCMA/Galway County Council.

Clients

Comhairle Chontae na Gaillimhe
Galway County Council

An Roinn Iompair Turasóireachta agus Spóirt
Department Transport, Tourism and Sport

TII
Transport Infrastructure Ireland

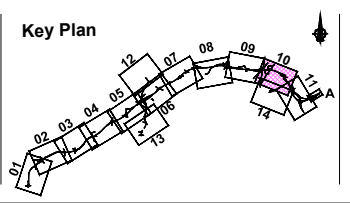

Consultant

ARUP

Corporate House
City East Business Park
Ballybrit, Galway, Ireland.

Tel +353 (0)91 460675
www.NGalwayCity.ie
www.arup.ie

Job Title
N6 Galway City Ring Road

Scale
1:5000 @ A3

Date:
February 2018

I3	22/02/2018	KJ	HK	EMC
I2	11/07/2017	PC	HK	EMC
I1	04/05/2017	PC	HK	EMC
Issue	Date	By	Chkd	Appd

Drawing Title
Section 50 Application
Plan Layout CH.13+800 to CH.15+500
Sheet 10 of 14

Drawing Status

For Information

Job No	Drawing No	Issue
233985	GCOB-500-D-510	13

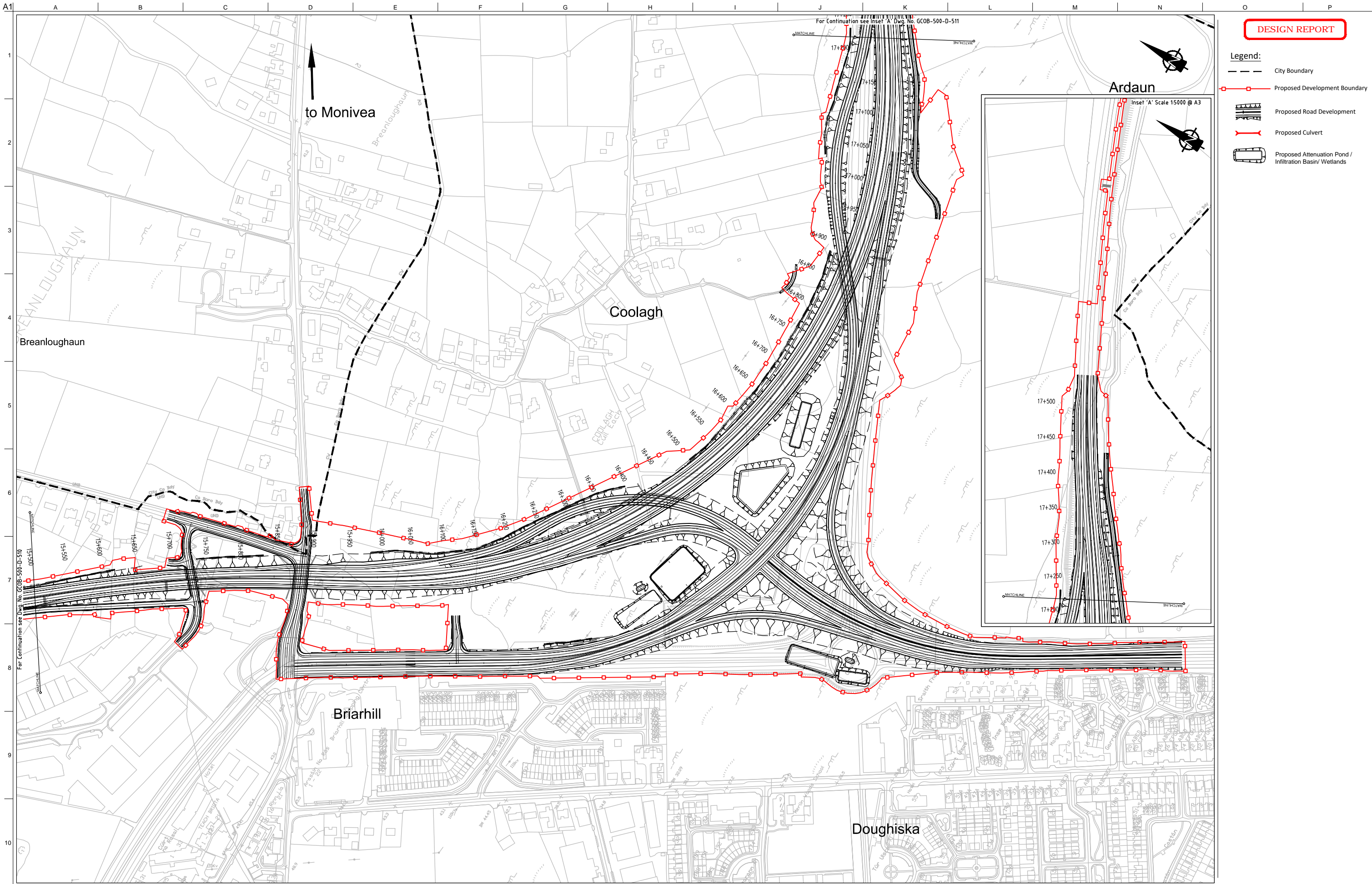

DESIGN REPORT

- Legend:**
- City Boundary
 - Proposed Development Boundary
 - Proposed Road Development
 - Proposed Culvert
 - Proposed Attenuation Pond / Infiltration Basin / Wetlands

Son áireamh tá sonraíocht Shuirbhíreachtí Orlánáis Éireann arna áitirgeadh fust Cheadúnas OSI Uimh. 2010/18CCMA/Comhairle Contae na Gaillimhe. Sírúinn áitirgeadh neamhdaraithe cóipeacht Shuirbhíreachtí Orlánáis Éireann agus Rialtas na hÉireann. © Suirbhíreacht Orlánáis Éireann, 2010.

© Suirbhíreacht Orlánáis Éireann. Gach ceart ar chosaint. Uimhir cheadúnais 2010/18CCMA/Comhairle Contae na Gaillimhe.

Includes Ordnance Survey Ireland data reproduced under OSI Licence number 2010/18CCMA/Galway County Council. Unauthorised reproduction infringes Ordnance Survey Ireland and Government of Ireland copyright. © Ordnance Survey Ireland, 2010.

© Ordnance Survey Ireland. All rights reserved. Licence number 2010/18CCMA/Galway County Council.

Clients

Comhairle Chontae na Gaillimhe
Galway County Council

Galway City Transport Project

An Roinn Iompair
Turastóireacht agus Spóirt

TII
Bonnagar Iompair Éireann

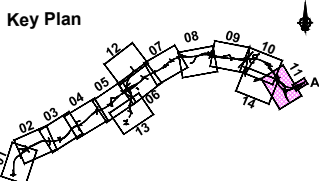

Consultant

ARUP

Corporate House
City East Business Park
Ballybrit, Galway, Ireland.

Tel +353 (0)91 460675
www.N6GalwayCity.ie
www.arup.ie

Job Title
N6 Galway City Ring Road

Scale
1:5000 @ A3

Date:
February 2018

I3	22/02/2018	KJ	HK	EMC
I2	11/07/2017	PC	HK	EMC
I1	04/05/2016	PC	HK	EMC
Issue	Date	By	Chkd	Appd

Drawing Title
Section 50 Application
CH.15+500 to CH.17+540 (End of Scheme)
Sheet 11 of 14

Drawing Status

For Information

Job No	Drawing No	Issue
233985	GCOB-500-D-511	13

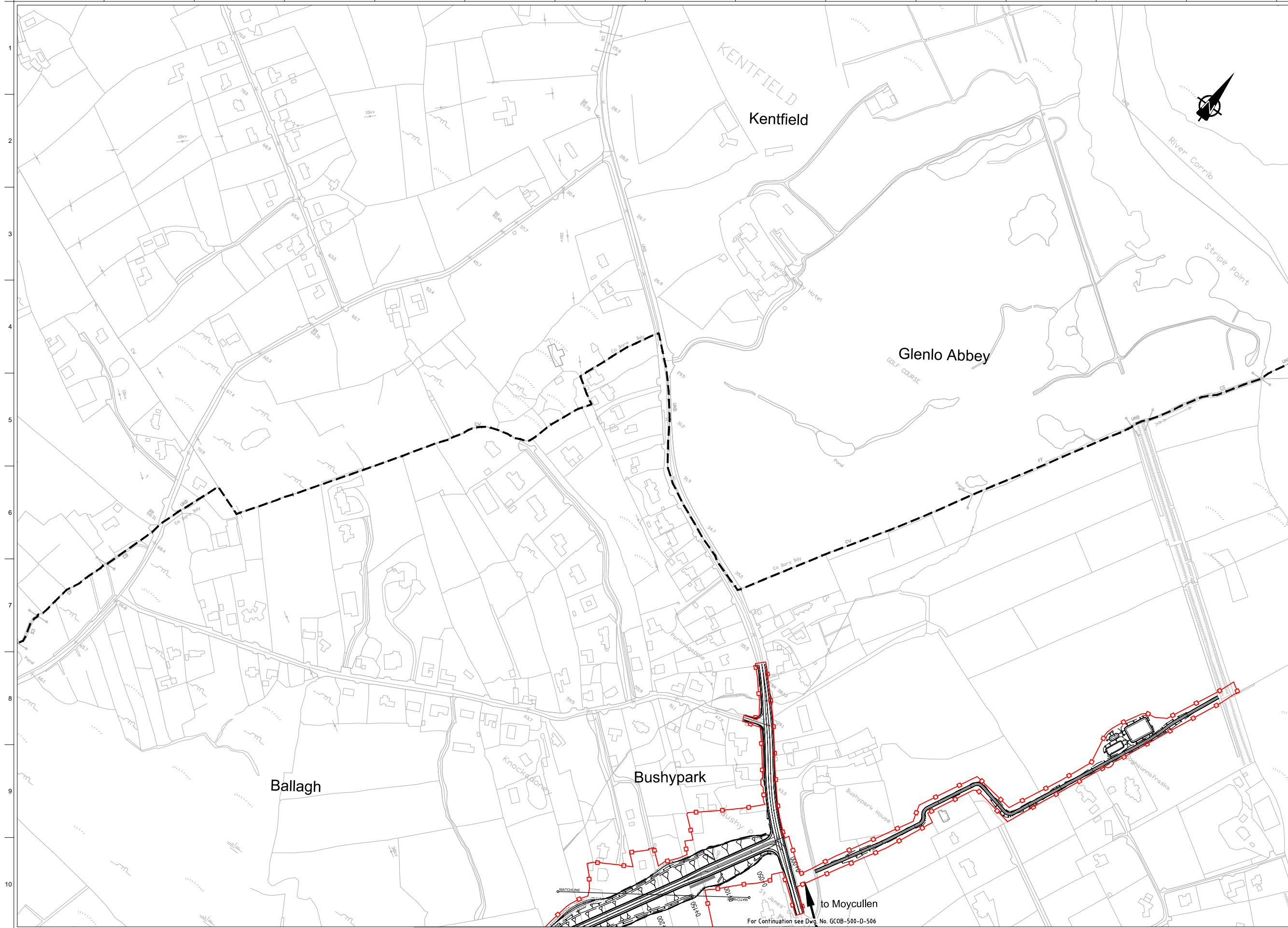

DESIGN REPORT

Legend:

- City Boundary
- Proposed Development Boundary
- Proposed Road Development
- Proposed Culvert
- Proposed Attenuation Pond / Infiltration Basin / Wetlands

Son áireamh tá sonraíocht Shuirbhíreachtí Ordánais Éireann arna atáirgeadh fust Cheadúnas OSI Uimh. 2010/18CCMA/Comhairle Contae na Gaillimhe. Sírtaíonn atáirgeadh neamhdaraithe cóipeacht Shuirbhíreachtí Ordánais Éireann agus Rialtas na hÉireann. © Suirbhíreachtí Ordánais Éireann, 2010.

© Suirbhíreachtí Ordánais Éireann. Gach ceart ar chosaint.
Uimhir cheadúnais 2010/18CCMA/Comhairle Contae na Gaillimhe.

Includes Ordnance Survey Ireland data reproduced under OSI Licence number 2010/18CCMA/Galway County Council. Unauthorised reproduction infringes Ordnance Survey Ireland and Government of Ireland copyright. © Ordnance Survey Ireland, 2010.

© Ordnance Survey Ireland. All rights reserved. Licence number 2010/18CCMA/Galway County Council.

Clients

 **Comhairle Chontae na Gaillimhe**
Galway County Council

 **N6 Galway City Transport Project**

 **An Roinn Iompair**
Turasóireachta agus Spóirt

 **TII**
Borradóir Iompair Éireann

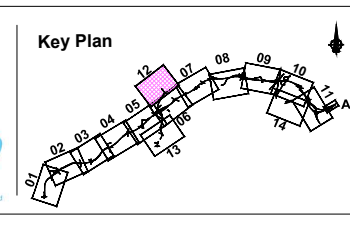

Consultant

ARUP

Corporate House
City East Business Park
Ballybrit, Galway, Ireland.

Tel +353 (0)91 460675
www.N6GalwayCity.ie
www.arup.ie

Job Title
N6 Galway City Ring Road

Scale
1:5000 @ A3

Date:
February 2018

I3	22/02/2018	KJ	HK	EMC
I2	11/07/2017	PC	HK	EMC
I1	04/05/2016	PC	HK	EMC
Issue	Date	By	Chkd	Appd

Drawing Title
Section 50 Application
N59 Link Road North
Sheet 12 of 14

Drawing Status

For Information

Job No	Drawing No	Issue
233985	GCOB-500-D-512	13

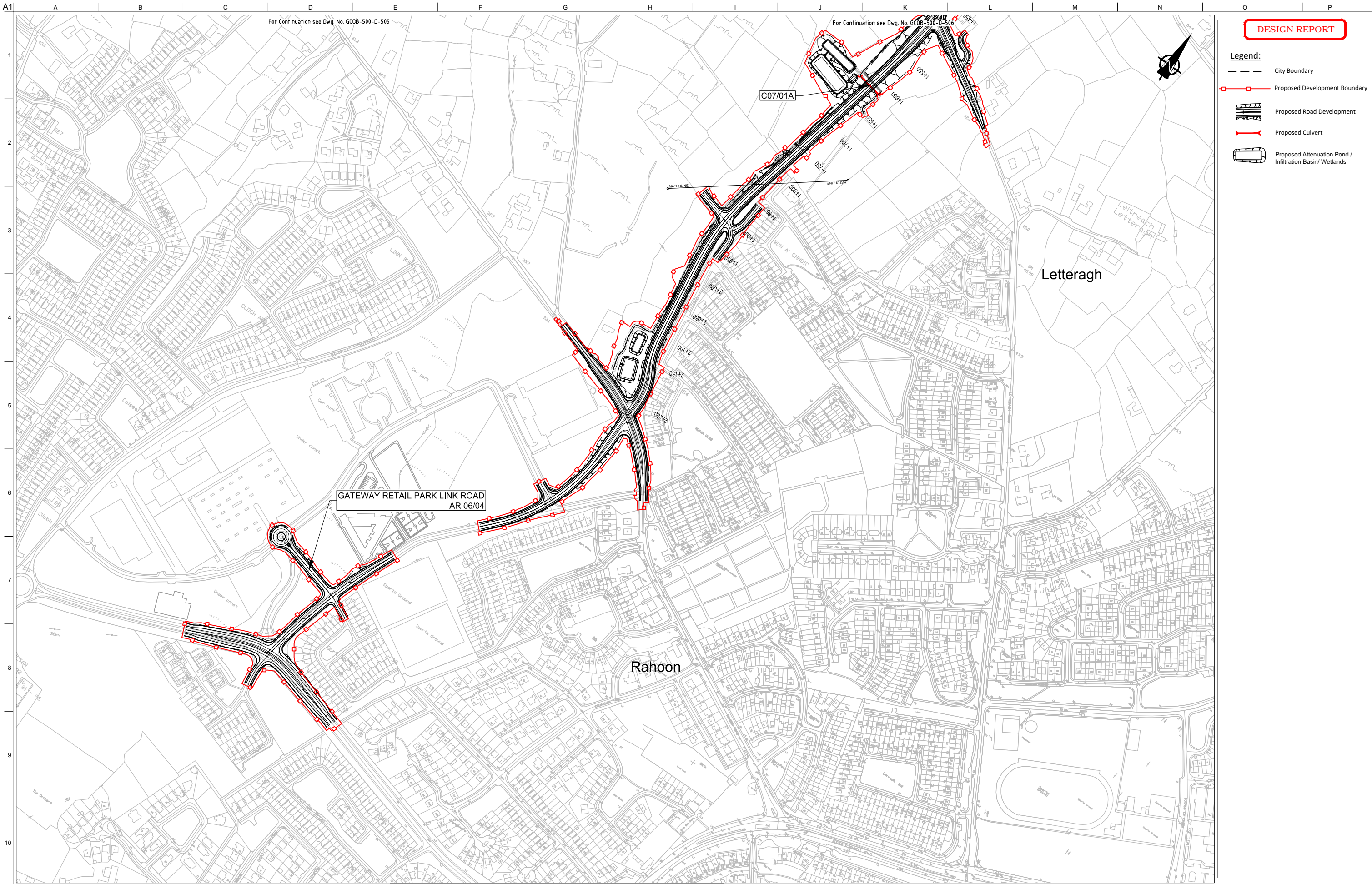

DESIGN REPORT

- Legend:**
- City Boundary
 - Proposed Development Boundary
 - Proposed Road Development
 - Proposed Culvert
 - Proposed Attenuation Pond / Infiltration Basin / Wetlands

A1
1
2
3
4
5
6
7
8
9
10

For Continuation see Dwg. No. GCOB-500-D-505

For Continuation see Dwg. No. GCOB-500-D-515

Son áireamh tá sonraíocht Shuirbhíreacht Orlánáis Éireann arna áitirgeadh fust Cheadúnas OSI Uimh. 2010/18CCMA/Comhairle Contae na Gaillimhe. Sírtaíonn áitirgeadh neamhdaraithe cóipeacht Shuirbhíreacht Orlánáis Éireann agus Rialtas na hÉireann. © Suirbhíreacht Orlánáis Éireann, 2010.

© Suirbhíreacht Orlánáis Éireann. Gach ceart ar chosaint. Uimhir cheadúnais 2010/18CCMA/Comhairle Contae na Gaillimhe.

Includes Ordnance Survey Ireland data reproduced under OSI Licence number 2010/18CCMA/Galway County Council. Unauthorised reproduction infringes Ordnance Survey Ireland and Government of Ireland copyright. © Ordnance Survey Ireland, 2010.

© Ordnance Survey Ireland. All rights reserved. Licence number 2010/18CCMA/Galway County Council.

Clients

Comhairle Chontae na Gaillimhe
Galway County Council

N6
Galway City Transport Project

An Roinn Iompair
Turasoireacht agus Spóirt

TII
Bonnagar Iompair Éireann

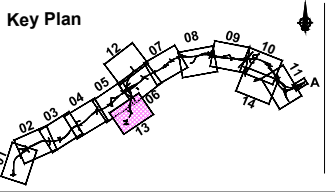

Consultant

ARUP

Corporate House
City East Business Park
Ballybrit, Galway, Ireland.

Tel +353 (0)91 460675
www.N6GalwayCity.ie
www.arup.ie

Job Title
N6 Galway City Ring Road

Scale
1:5000 @ A3

Date:
February 2018

I3	22/02/2018	KJ	HK	EMC
I2	11/07/2017	PC	HK	EMC
I1	04/05/2016	PC	HK	EMC
Issue	Date	By	Chkd	Appd

Drawing Title
Section 50 Application
N59 Link Road South
Sheet 13 of 14

Drawing Status

For Information

Job No	Drawing No	Issue
233985	GCOB-500-D-513	13

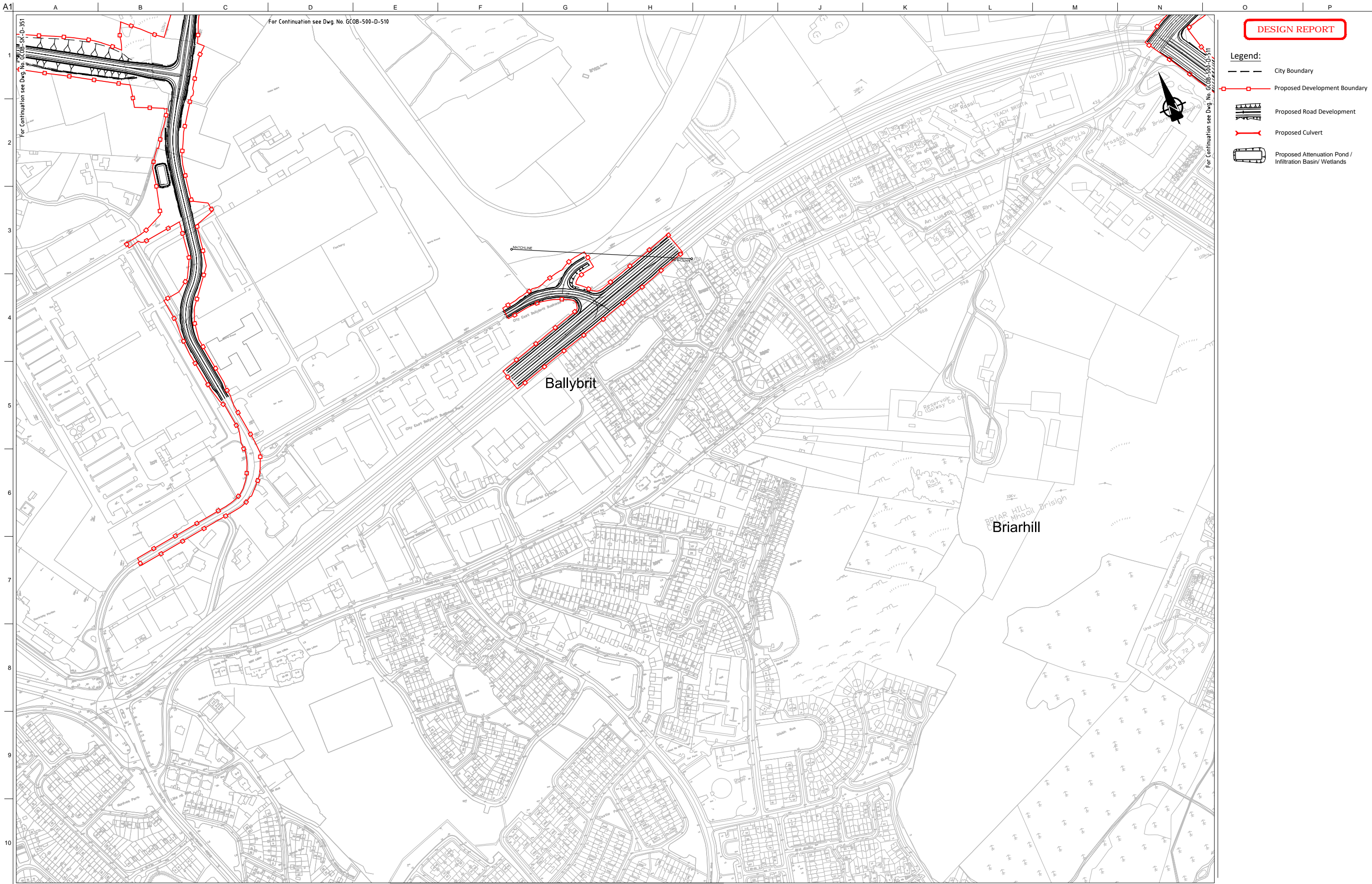

DESIGN REPORT

- Legend:**
- City Boundary
 - Proposed Development Boundary
 - Proposed Road Development
 - Proposed Culvert
 - Proposed Attenuation Pond / Infiltration Basin / Wetlands

San áireamh tá sonraíocht Shuirbhíreacht Orlánais Éireann arna aistriú go dtí fás Cheadúnas OSI Uimh. 2010/18CCMA/Comhairle Contae na Gaillimhe. Sírúinn aistriú go dtí neamhdarúithe cóipeacht Shuirbhíreacht Orlánais Éireann agus Rialtas na hÉireann. © Suirbhíreacht Orlánais Éireann, 2010.

© Suirbhíreacht Orlánais Éireann. Gach ceart ar chosaint. Uimhir cheadúnais 2010/18CCMA/Comhairle Contae na Gaillimhe.

Includes Ordnance Survey Ireland data reproduced under OSI Licence number 2010/18CCMA/Galway County Council. Unauthorised reproduction infringes Ordnance Survey Ireland and Government of Ireland copyright. © Ordnance Survey Ireland, 2010.

© Ordnance Survey Ireland. All rights reserved. Licence number 2010/18CCMA/Galway County Council.

Clients

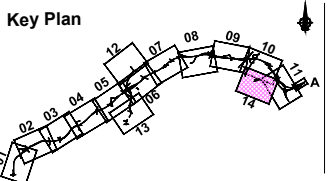

Consultant

Corporate House
City East Business Park
Ballybrit, Galway, Ireland.

Tel +353 (0)91 460675
www.N6GalwayCity.ie
www.arup.ie

Job Title
N6 Galway City Ring Road

Scale
1:5000 @ A3

Date:
February 2018

I3	22/02/2018	KJ	HK	EMC
I2	11/07/2017	PC	HK	EMC
I1	04/05/2016	PC	HK	EMC
Issue	Date	By	Chkd	Appd

Drawing Title
Section 50 Application
City East Business Park Junction
Sheet 14 of 14

Drawing Status

For Information

Job No	Drawing No	Issue
233985	GCOB-500-D-514	13